

vtech[®]

User's Manual

Lil' Speller Phonics Station™



© 2014 VTech
Printed in China
91-009684-000 US CA

Dear Parent,

At **VTech**[®], we know how important the first day of school is for your child. To help prepare preschoolers for this important event, **VTech**[®] has developed the **Preschool Learning**[™] series of interactive toys.

Preschool Learning[™] features fun characters and inviting school themes that use technology to capture a child's attention and teach important preschool skills like spelling, counting and the alphabet. These vital skills are taught in a way that's both fun and highly engaging to maintain a child's interest. Children will also be introduced to fun school subjects such as art class, music class and even recess! With **Preschool Learning**[™], learning is fun from day one!

At **VTech**[®], we know that a child has the ability to do great things. That's why all of our electronic learning products are uniquely designed to develop a child's mind and allow them to learn to the best of their ability. We thank you for trusting **VTech**[®] with the important job of helping your child learn and grow!

Sincerely,

Your friends at **VTech**[®]

To learn more about **Preschool Learning**[™] series and other **VTech**[®] toys, visit www.vtechkids.com

INTRODUCTION

Thank you for purchasing the **VTech® Lil' Speller Phonics Station™**! The **Lil' Speller Phonics Station™** allows your child to explore the world of letters, phonics, spelling and rhyming. Explore letters and their sounds one by one and build over 200 words. With an animated LCD screen to reinforce learning, plus fun sounds and melodies, there's always something new to discover with the **Lil' Speller Phonics Station™**.

30 LETTER BLOCKS:
26 LETTER BLOCKS
PLUS EXTRA
d/e/m/o BLOCKS

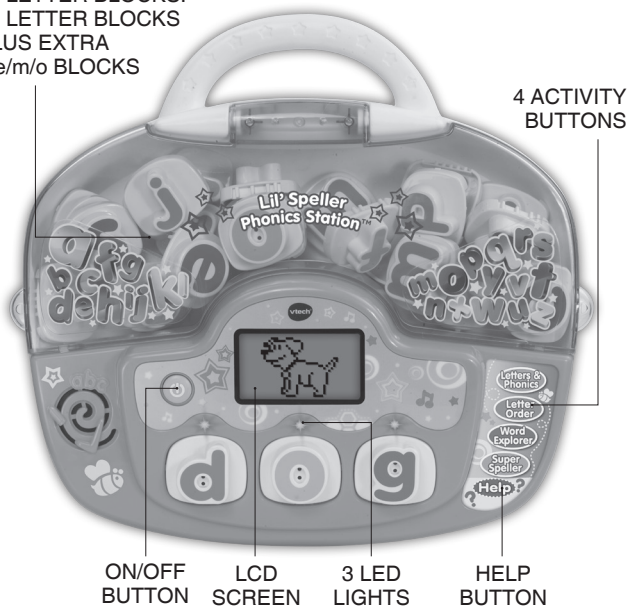

INCLUDED IN THIS PACKAGE

- One VTech® Lil' Speller Phonics Station™
- 26 letter blocks plus extra d/e/m/o blocks
- One User's Manual

WARNING:

All packing materials, such as tape, plastic sheets, packaging locks and tags are not part of this toy, and should be discarded for your child's safety.

ATTENTION

Pour la sécurité de votre enfant, débarrassez-vous de tous les produits d'emballage tels que rubans adhésifs, feuilles de plastique, attaches et étiquettes. Ils ne font pas partie du jouet.

NOTE: Please keep instruction manual as it contains important information.

Unlock the packaging locks:

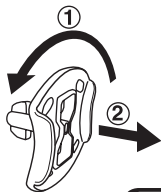

① Rotate the packaging lock counter-clockwise 90 degrees.

② Pull out the packaging lock.



INCLUDED IN THIS PACKAGE

4

GETTING STARTED

RELEASE THE TRY-ME BLOCKS

1. Make sure the unit is turned **OFF**.
2. Carefully pull the try-me blocks away from the toy and cut the strings as illustrated.
3. Then, remove the strings from the front of the toy.
4. Please insert letter blocks (other than “d”, “o”, “g”) into the slot before you turn on the unit to activate normal play.



BATTERY INSTALLATION

1. Make sure the unit is turned **OFF**.
2. Locate the battery cover on the bottom of the unit. Use a screwdriver or coin to loosen the screw.
3. Install 2 new “AA” size (LR6/AM-3) batteries following the diagram inside the battery box. (The use of new alkaline batteries is recommended for maximum performance.)
4. Replace the battery cover and tighten the screw to secure.

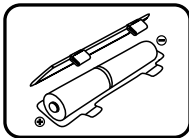

BATTERY NOTICE

- Use new alkaline batteries for maximum performance.
- Use only batteries of the same or equivalent type as recommended.
- Do not mix different types of batteries: alkaline, standard (carbon-zinc) or rechargeable (Ni-Cd, Ni-MH), or new and used batteries.

- Do not use damaged batteries.
- Insert batteries with the correct polarity.
- Do not short-circuit the battery terminals.
- Remove exhausted batteries from the toy.
- Remove batteries during long periods of non-use.
- Do not dispose of batteries in fire.
- Do not charge non-rechargeable batteries.
- Remove rechargeable batteries from the toy before charging (if removable).
- Rechargeable batteries are only to be charged under adult supervision.

PRODUCT FEATURES

1. ON / OFF BUTTON

Press the **On/Off** Button to turn the unit **ON**. Press again to turn the unit **OFF**.



2. ACTIVITY BUTTONS

Press the **Activity Buttons** to select an activity to play.



3. HELP BUTTON

Press the **Help** Button to hear the question or the corresponding hint.



4. 3 LED LIGHTS

Blinking **Lights** guide your child letter by letter.



5. 30 LETTER BLOCKS

Insert any of the **26 Letter Blocks** and **4 Extra d/e/m/o Blocks** to make a word or answer questions (in some modes).

To insert **Letter Blocks**:

- Place the **Letter Block** on the slot.
- Press down on the middle or bottom area of **Letter Block** to press it into unit.



If you do not receive a response after the letter block is inserted, please reinsert it.

6. VOLUME SWITCH

Switch the **Volume Switch** to adjust the volume.

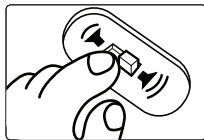

7. AUTOMATIC SHUT-OFF

To preserve battery life, the **VTech® Lil' Speller Phonics Station™** will automatically turn off after several minutes without input. The unit can be turned on again by pressing the **On/Off Button**.

ACTIVITIES

1. LETTERS & PHONICS

Time to learn letters and phonics. Insert the **Letter Block** into any slot to hear the letter name and phonic sound.



2. LETTER ORDER

Watch carefully to see which letter is missing. Plug in the correct **Letter Block** to complete the correct letter order.



3. WORD EXPLORER

Put in 3 **Letter Blocks** to spell a word! Let's see how many words you can make.



4. SUPER SPELLER

Spelling time! The Spelling Bee will show a 3-letter word and a corresponding picture. Then plug in **Letter Blocks** to spell the word. After you spell several words successfully, you will automatically advance to a bonus round where you will spell rhyming words.



CARE & MAINTENANCE

1. Keep the unit clean by wiping it with a slightly damp cloth.
2. Keep the unit out of direct sunlight and away from any direct heat source.
3. Remove the batteries when the unit is not in use for an extended period of time.
4. Do not drop the unit on hard surfaces and do not expose the unit to moisture or water.

TROUBLESHOOTING

If for some reason the program/activity stops working or malfunctions, please follow these steps:

1. Turn the unit **OFF**.
2. Interrupt the power supply by removing the batteries.
3. Let the unit stand for a few minutes, then replace the batteries.
4. Turn the unit back **ON**. The unit will now be ready to play again.
5. If the product still does not work, replace with a new set of batteries.

If the problem persists, please call our Consumer Services Department at 1-800-521-2010 in the U.S., or 1-877-352-8697 in Canada, and a service representative will be happy to help you.

For information on this product warranty, please call **VTech**® at 1-800-521-2010 in the U.S. or 1-877-352-8697 in Canada.

IMPORTANT NOTE:

Creating and developing **VTech® Preschool Learning** products is accompanied by a responsibility that we at **VTech®** take very seriously. We make every effort to ensure the accuracy of the information, which forms the value of our products. However, errors sometimes can occur. It is important for you to know that we stand behind our products and encourage you to call our Consumer Services Department at 1-800-521-2010 in the U.S., or 1-877-352-8697 in Canada, with any problems and/or suggestions that you might have. A service representative will be happy to help you.

Note:

This equipment has been tested and found to comply with the limits for a Class B digital device, pursuant to Part 15 of the FCC Rules. These limits are designed to provide reasonable protection against harmful interference in a residential installation. This equipment generates, uses and can radiate radio frequency energy and, if not installed and used in accordance with the instructions, may cause harmful interference to radio communications. However, there is no guarantee that interference will not occur in a particular installation. If this equipment does cause harmful interference to radio or television reception, which can be determined by turning the equipment off and on, the user is encouraged to try to correct the interference by one or more of the following measures:

- Reorient or relocate the receiving antenna.
- Increase the separation between the equipment and receiver.
- Connect the equipment into an outlet on a circuit different from that to which the receiver is connected.
- Consult the dealer or an experienced radio/TV technician for help.

Caution: changes or modifications not expressly approved by the party responsible for compliance could void the user's authority to operate the equipment.